

RESOLUTION

**FOR MAINTENANCE AND OWNERSHIP
OF
HIGH STREET TURNAROUND**

BE IT RESOLVED, that the City of Somerset agrees to accept ownership and maintain or cause to maintain the following facilities.

High Street Turnaround – From the junction with High Street (CS 1176) and extending east to the end of pavement, a distance of approximately 0.01 miles (See Exhibit "A.1").

The City of Somerset does hereby resolve and agree to accept the proposal and conditions set forth in this Resolution. We understand that Kentucky Transportation Cabinet Official Orders and quitclaim deeds will be issued for the assignments and transfers of maintenance responsibility and ownership interest of the facilities upon our acceptance of this agreement and at the completion of the aforementioned project.

The foregoing Resolution was adopted as above set forth by majority roll call vote of all members of the City council present, a quorum being constituted and said Resolution has been duly made a permanent part of the minutes of the City Council.

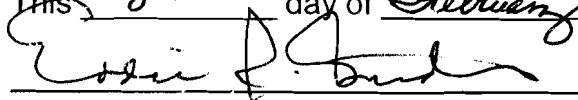
This 8th day of February, 2010.

Eddie Girdler - Mayor, City of Somerset

ATTEST:  City Clerk

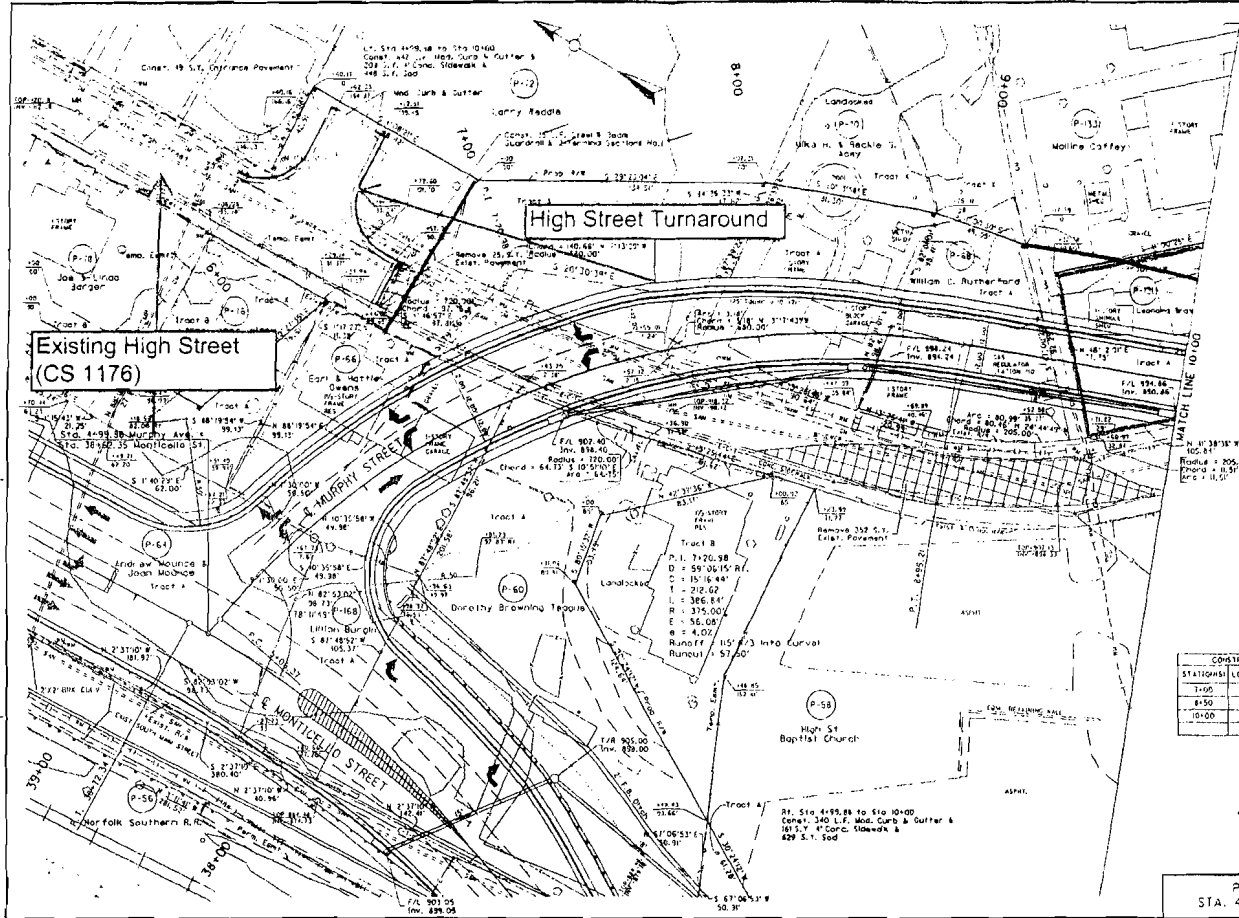

CONSTRUCT DRAINAGE STRUCTURE			
STATIONING	LOCATION	STRUCTURE TYPE	WIDTH
1+05	Rt.	C.B.I. Type 1	1'x10'
4+50	Rt.	C.B.I. Type 1	1'x10'
10+00	Rt.	C.B.I. Type 1	1'x10'

EXHIBIT A.1

Scale: 1" = 20'

PLAN MURPHY AVE.
 STA. 4+99.88 TO STA. 10+00