

ORDINANCE NUMBER 12-13

AN ORDINANCE TO THE CITY OF SOMERSET, KENTUCKY, ANNEXING BY CONSENT PROPERTY AS DESCRIBED BELOW AND IN ATTACHMENTS TO THIS ORDINANCE, ATTACHMENTS INCORPORATED IN FULL BY REFERENCE HEREIN; AND

WHEREAS, ANNEXATION REQUEST FORMS HAVE BEEN SUBMITTED BY THE PROPERTY OWNERS, AND THE FORMS HAVE BEEN ACCEPTED BY THE CITY AS COMPLETED; AND THE PROPERTY OWNERS EACH HAVING WAIVED THE 60 DAY WAITING PERIOD, BY AND THROUGH THE ANNEXATION REQUEST FORM, SIGNED BY THE OWNER AND/OR AN AUTHORIZED AGENT OF THE OWNER AND INCORPORATED IN FULL HEREIN BY REFERENCE, AND MADE PART OF THE ATTACHMENTS TO THIS ORDINANCE; AND

WHEREAS, ALL DOCUMENTS AND RECORDS NEEDED TO PROCEED WITH ANNEXATION OF THE PROPERTIES INTO THE CORPORATE LIMITS OF THE CITY OF SOMERSET; AND

WHEREAS, THE PROPERTIES MEET ALL REQUIREMENTS FOR ANNEXATION AS SET FORTH IN KRS AND ALL OTHER APPLICABLE LAW;

NOW THEREFORE, BE IT ORDAINED BY THE CITY OF SOMERSET, KENTUCKY:

SECTION 1. THAT THE PROPERTIES DESCRIBED IN ATTACHMENTS HERETO, ATTACHMENTS INCORPORATED IN FULL BY REFERENCE, ARE HEREBY ANNEXED INTO THE CITY'S CORPORATE LIMITS.

2601 KENTUCKY HIGHWAY 39-NELSON VALLEY GROCERY

SECTION 2. THIS ORDINANCE SHALL TAKE EFFECT AFTER ITS PASSAGE AND UPON PUBLICATION BY LAW.

FIRST READING: August 13, 2012

SECOND READING: August 27, 2012

APPROVED Edward R. Girdler
EDWARD R. GIRDLER, MAYOR
CITY OF SOMERSET, KENTUCKY

ATTEST: David Godsey
DAVID GODSEY, CITY CLERK

ANNEXATION REQUEST FORM

I, SANJAY S. PATEL formally request annexation

Of my property located

at 2601 HWY 39 SOMERSET

K4-4250.3 into the City of Somerset.

I also request that the 60 day waiting period be waived.

I am requesting that my property be zoned B2.

Sincerely,

Sanjay Patel

Date 8/2/12

2601 North Highway 39

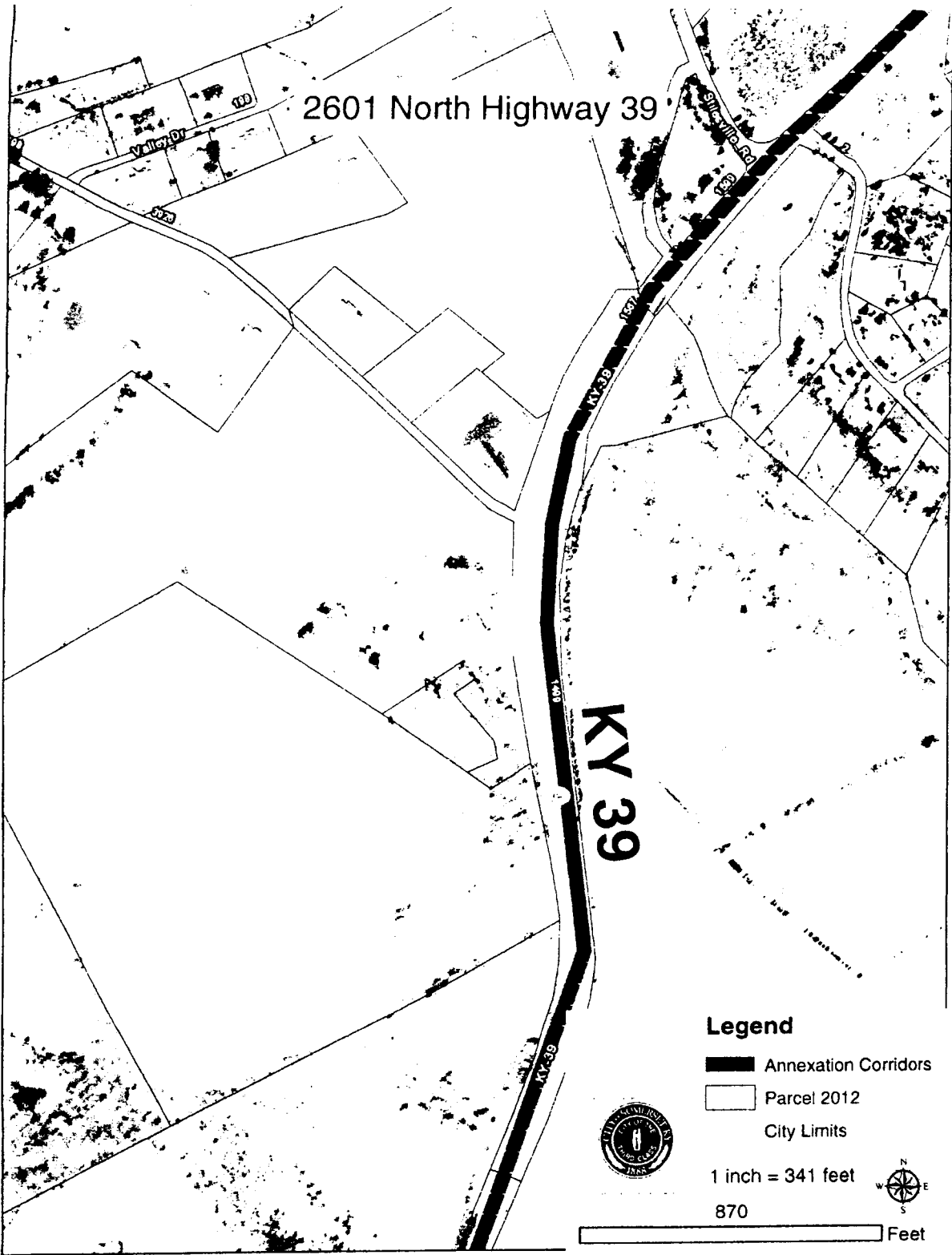

Legend

 Annexation Corridors

 Parcel 2012

 City Limits

1 inch = 341 feet

870



Feet

